

GvK's Glaive Design (Update Feb 2007):

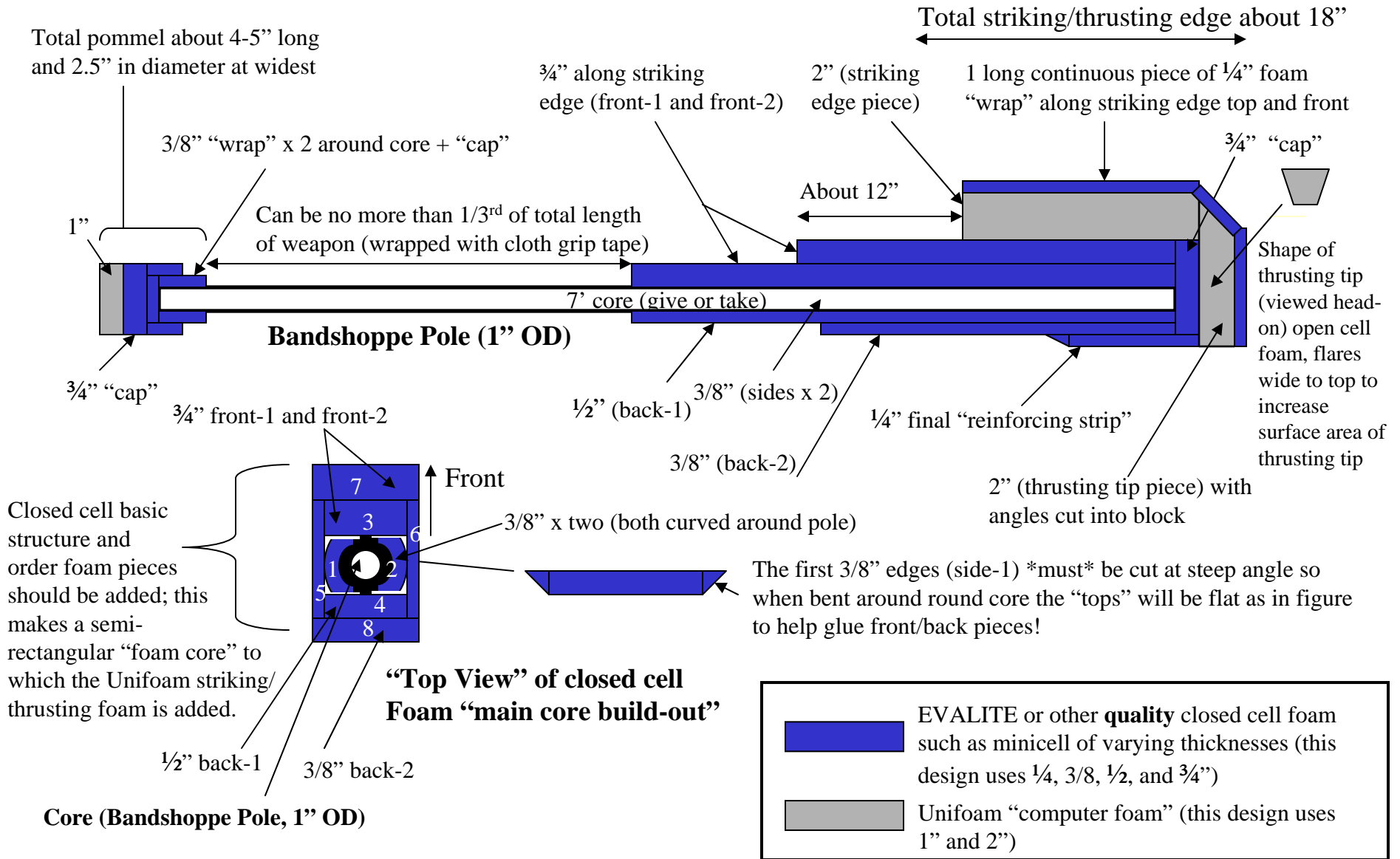

Reinforcing the Thrusting Tip: 3 Steps

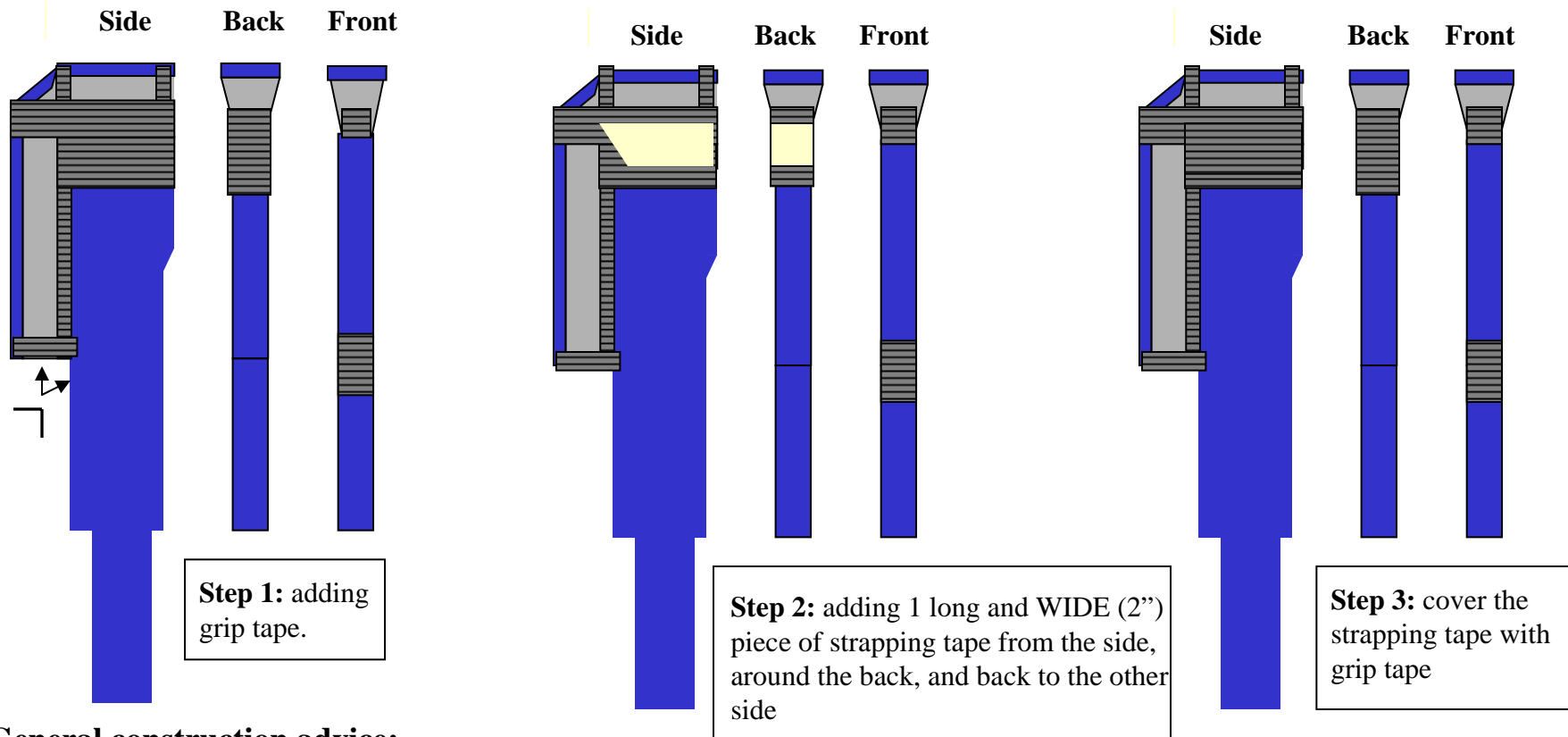

General construction advice:

- Sand away the top “plasticity” coating of the bandshoppo pole **FIRST**, use gloves, eye protection, and a mask for safety.
- Use quarters and strapping tape to cover the pole ends first, to prevent the core cutting the foam.
- Use DAP for all closed cell to closed cell foam bonds and closed cell to the core bonds, use high quality spray adhesive for open cell to open cell and open cell to closed cell bonds.
- Reinforce ALL closed cell to closed cell bonds that ARE going to be covered by another layer of closed cell foam with narrow strips (~ ½”) of strapping tape using a thin coat of DAP to help secure the tape. Use thin strips of duct tape for reinforcing those closed cell bonds that will NOT be covered by another layer of closed cell foam.
- Use cloth grip tape (wide and narrow) to reinforce the open cell foam tip and the final closed cell wrap and bonds, minimizing tape that goes over the striking edges (on the flats and along the back is okay) and using spray adhesive to help secure the grip tape to the foam.
- Some CAREFUL use of wide strapping tape along the sides and along the back of the glaive (NOT the striking edges!) to support the thrusting tip is **necessary**. Use grip tape to cover ALL exterior strapping tape.